



With the **beauty** of a castle, the **safety** of a fortress, and the **comfort** of a retreat, a home built with **BuildBlock® insulating concrete forms** is truly a dream home.

You'll think you're dreaming when you see the tremendous heating and cooling savings, but we assure you, they're real!

## What are ICFs?



Insulating concrete forms (ICFs) are hollow Expanded Polystyrene (EPS) **foam blocks** which are stacked into the shape of the exterior

walls of a building, reinforced with **steel rebar**, and then filled with **concrete**. The foam panels are held together by high-density plastic webs. Interior and exterior wall finishes are easily installed to **attachment points** on the webs.

The result is a wall system of unmatched comfort, energy efficiency, noise reduction and strength.

*Surround your family in the comfort and protection of concrete.*

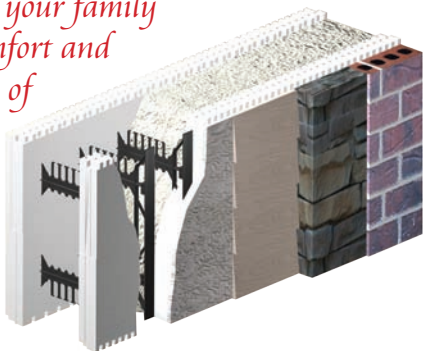

## BuildBlock Specifications

Form Type	Length	Return	Area sq.ft.	Concrete Vol. cu.yd.
<b>4" PRODUCT LINE</b>		Width: 9" Height: 16"		
Straight	48"	N/A	5.33	.065844
90° Corner	Ext: 31"/ Int: 22"	Ext: 19"/ Int: 10"	5.56	.054574
45° Corner	Ext: 28" Int: 24.272"	Ext: 16" Int: 12.272"	4.89	.054985
<b>6" PRODUCT LINE</b>		Width: 11" Height: 16"		
Straight	48"	N/A	5.33	.098765
90° Corner	Ext: 33"/ Int: 22"	Ext: 21"/ Int: 10"	6.00	.086528
45° Corner	Ext: 28" Int: 23.444"	Ext: 16" Int: 11.444"	4.89	.080841
Brick Ledge*	48"	N/A	5.33	.134148
Double Taper Top**	48"	N/A	5.33	.130128
<b>8" PRODUCT LINE</b>		Width: 13" Height: 16"		
Straight	48"	N/A	5.33	.131687
90° Corner	Ext: 35"/ Int: 22"	Ext: 23"/ Int: 10"	6.44	.121517
45° Corner	Ext: 28" Int: 22.615"	Ext: 16" Int: 10.615"	4.89	.105425
Brick Ledge*	48"	N/A	5.33	.167074
Double Taper Top**	48"	N/A	5.33	.16305
*Brick Ledge Corbels Only (6" and 8")				.035556
**Double Taper Top Corbels Only (6" and 8")				.031363

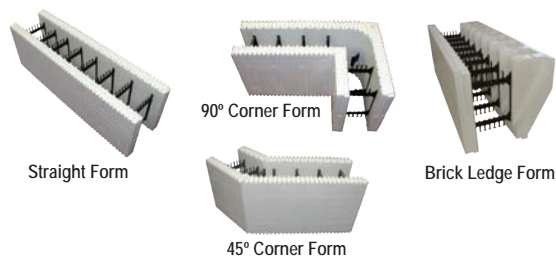

9701 N. Broadway Ext. • Oklahoma City, OK 73114  
Toll-Free: 866-222-2575 • Phone: 405-840-3386

The stuff  
*dreams*  
are made of.



Beautiful, safe,  
and comfortable  
dream homes made with



*Build it once. Build it for life.*

Visit [www.buildblock.com](http://www.buildblock.com) or contact your BuildBlock Distributor or Dealer.

# Right from the start

As you begin formulating the plans for your new home, there seems to be no end to the number of choices you have to make. It's natural to pour hours of time and effort into choosing the wall coverings, exterior finish and other aesthetics for your new home. But first take some time to decide what will be *inside* those walls.

Traditional wood-frame or CMU construction can't compare to the comfort, safety, sustainability, and energy efficiency of walls built with BuildBlock® insulating concrete forms.

## Quiet Comfort

75% less outside air infiltrates a BuildBlock ICF home.

- ◆ Stable room temperatures
- ◆ No hot spots, no cold drafts
- ◆ Greatly reduced pollen, allergens, and dust

ICF homes are **3 times quieter** than wood-frame homes.

## Safe and Sound

BuildBlock ICFs create a monolithic concrete wall that is **10 times stronger** than a wood-frame wall. BuildBlock homes can withstand **hurricane and tornado strength winds** and are **fire and earthquake resistant**. A small room or master bedroom closet can be built as a **FEMA-approved safe room** to protect your family and valuables. The strength and durability of BuildBlock ICFs not only **increase the resale value** of your home but may qualify you for **lower insurance premiums**.

## Design Freedom

In addition to the many ICF home plans now available, **virtually any home plan** can be adapted for BuildBlock ICFs. Also, because of the innate flexibility of the foam material you can have unique footprints, arches, angles and curves as part of your design. Exterior walls can be finished with brick, masonry, stone, stucco or siding.



BuildBlock walls keep  
the outside world...  
outside.

## Energy Efficiency & Savings

At a time when energy costs are soaring, it makes more sense to spend money on a safer, longer lasting, and more energy efficient home than to spend that same money on utility bills. Depending on the climate, BuildBlock homeowners enjoy a **30 - 70% savings** in heating and/or cooling costs!

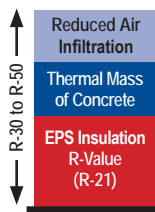

The **Total Effective R-Value** performance of BuildBlock ICFs consists of three factors: the R-Value of the expanded polystyrene, the **thermal mass** of the concrete, and the enormous **reduction in air leakage** (infiltration).

With the combined performance of these three factors, ICF walls actually perform **as high as R-50** in some areas of the country. This energy efficiency directly contributes to **LEED Certification** and may qualify you for **tax credits** and deductions as well as an Energy Efficient Mortgage.

## Earth-Friendly

Building with BuildBlock ICFs **saves trees**. The enormous reduction in energy use saves our **natural resources** and **reduces** the amount of carbon dioxide released into the atmosphere. BuildBlock ICFs contain no HCFC, formaldehyde, asbestos, or fiberglass, and no harmful CFCs are used in their manufacture.



## Choose BuildBlock

All ICFs are not created equal. BuildBlock ICFs have many features that make them easier and faster to install, **saving construction time and money.**

- ◆ Molded-in "tape measure"
- ◆ Molded-in horizontal cut lines
- ◆ Deep, snap-in rebar fingers
- ◆ Fully reversible
- ◆ Secure, interlocking connections
- ◆ Near full-height, high-density plastic webs
- ◆ Webs molded-in on 6-inch centers
- ◆ Heavy-duty attachment points (450 lbs. +)
- ◆ Ready to stack; no onsite assembly
- ◆ Industry standard size: 16" high x 48" long

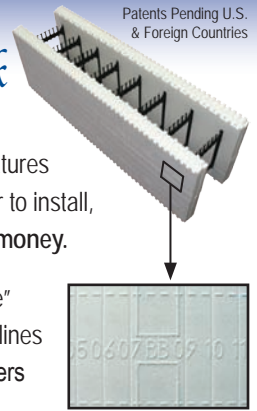

Our 2½" wide, 6" x 6" long corner web holds rebar in place and provides superior attach points for exterior finishes. Combined with the extra length of our corner forms, this adds **strength and stability** during the concrete pour and virtually eliminates the need for strapping.

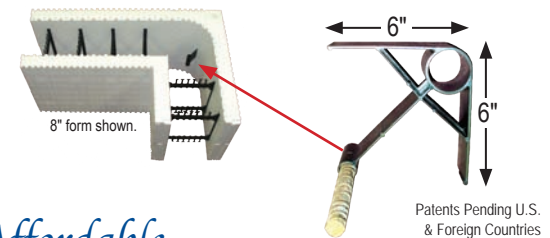

## Affordable

BuildBlock is one of the most technically advanced ICFs on the market and one the most affordable as well. Can you really afford **not** to build with BuildBlock?

Live happily ever after...

in a home built with

